

Screen area

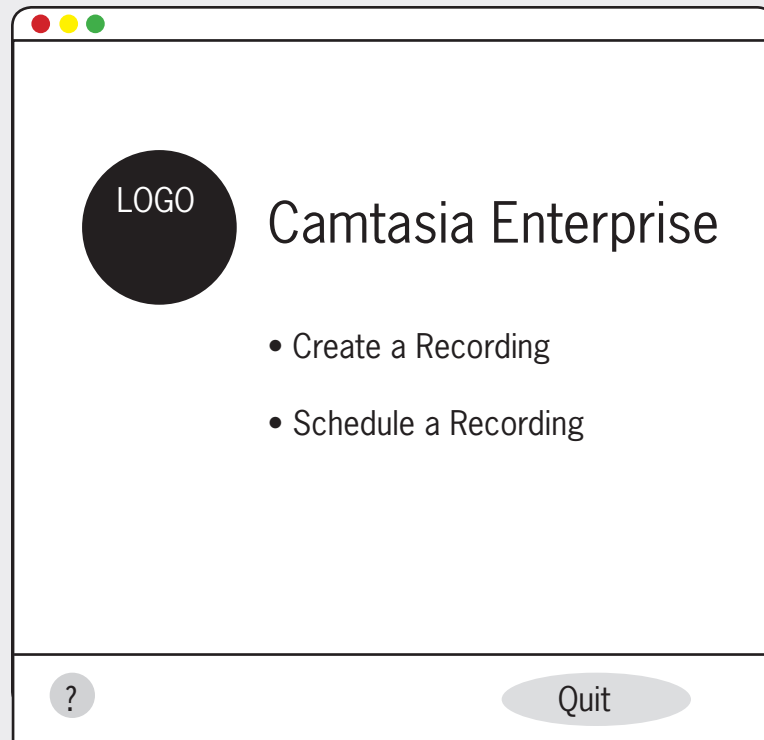

Screen area

The screenshot shows the 'Audio Input' tab of the Camtasia Enterprise software. The interface includes a 'Preview' window with a 'Video Preview (Live)' area and a 'Second Screen' area. To the right of the preview is an audio level meter with two vertical bars and a horizontal line with a triangle slider. Below the meter is a microphone icon and a volume control slider. The bottom of the window features a menu bar with a help icon, the Camtasia logo, the text 'Camtasia Enterprise', and 'Quit' and 'Start' buttons.

Preview Audio Input Saving Quality

Video Preview (Live)

Second Screen

Text about appropriate audio levels.

Lines move with input.

● Edit Recording area

? LOGO Camtasia Enterprise Quit Start

Screen area

The screenshot shows a software window titled "Camtasia Enterprise" with a standard macOS-style title bar (red, yellow, green buttons). The window is divided into four tabs: "Preview", "Audio Input", "Saving", and "Quality". The "Audio Input" tab is active. It contains two columns of vertical bars representing audio levels, with text explaining that the lines move with input. Below this is a volume slider with two microphone icons. To the right is a list of audio input sources, with "Internal Mic" selected. The bottom of the window features a toolbar with a help icon (?), a logo, the text "Camtasia Enterprise", and "Quit" and "Start" buttons.

Preview Audio Input Saving Quality

Text about appropriate audio levels.

Lines move with input.

List of Audio Input Sources

Internal Mic
External Mic

? LOGO Camtasia Enterprise Quit Start

Screen area

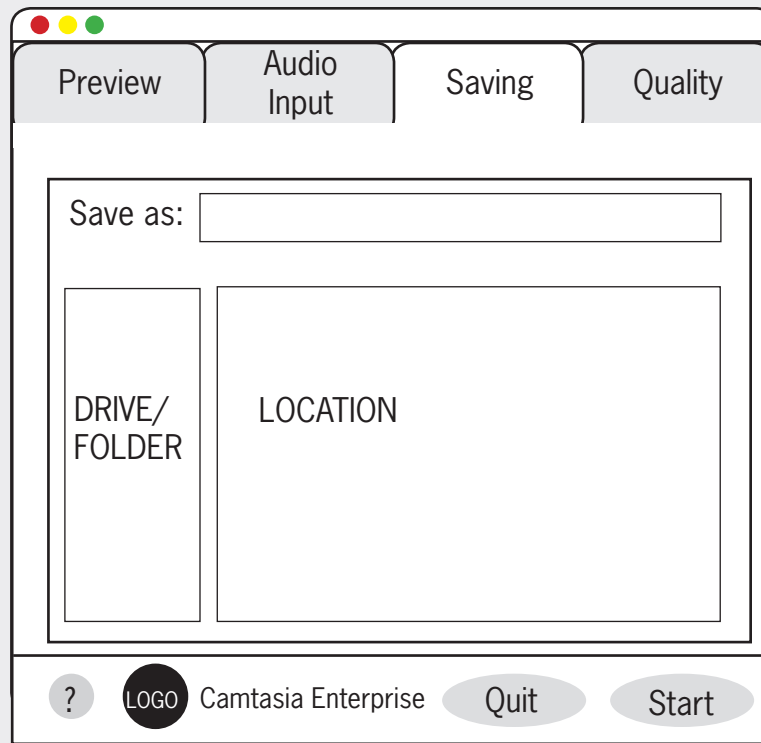

Screen area

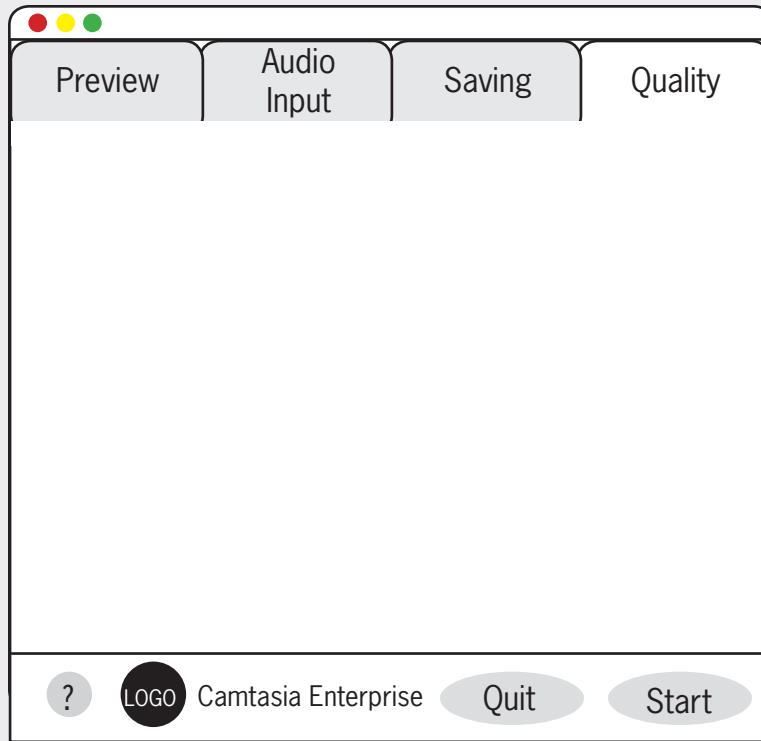

Screen area

Schedule or Edit a Scheduled Recording

Date 

Start Time ^ v

End Time ^ v

Repeat Weekly

Repeat Monthly

List of Recordings

Date/Time

Date/Time

+ -

? LOGO Camtasia Enterprise Quit Start



Logo with feedback for Audio
and Video Recording

Screen area

